



产 品 承 认 书

Specification for Approval

客 户 : _____
Customer

客 户 料 号 : _____
Customer P/N

物 料 名 称 : _____
Item Name

瑞 申 料 号 : **RSER42 系列规格书**
Ruishen P/N

承 认 书 编 号 : **S22010828**
Spec No.

版 本 号 : **A0**
Version No.

制 造 商 Manufacture	
拟 制 Prepared	黄 荣 英
审 核 Checked	王 康
批 准 Approved	田 一
日 期 Date	2022-01-08

客 户 承 认 Approved by Customer	
批 准 Approved	
日 期 Date	

备 注:
Remark

1. 在使用产品前，用户必须确认此产品是否适用于自身设计，瑞申仅保证产品符合此份承认书的规格。
Before use, customer should confirm whether this product is suitable for their design, Ruishen only ensure products meet this specification.
2. 本承认书的数据更改，必须经双方确认，任何一方单独修改无效。
This specification data change must be confirmed by both parties, any individual modification is invalid.
3. 如客户未回签承认书即下订单，则视为承认此份承认书。
If customer placed orders without signing back this specification, it is regarded as recognition.

深圳市瑞申电子有限公司

Shenzhen Ruishen Electronics Co., Ltd

深圳市龙岗区宏泰街 1 号金佰亿创业园 3 栋 2 楼
Floor 2, building 3, Jinbaiyi Pioneer Park, No. 1, Hongtai street,
Longgang District, Shenzhen TEL: 18126382251

1 电气特性

Electrical characteristics

料号 Part No.	电感值 Inductance (μH) ※1	直流电阻 DC Resistance ($\text{m}\Omega$)		温升电流 Heat Rating Current (A) ※2	饱和电流 Saturation Current (A) ※3	
	$\pm 20\%$	Typical	Max	Typical	20% drop	30% drop
RSER42-3R6M	3.6	0.47	0.52	173	331	442
RSER42-5R6M	5.6	0.47	0.52	173	188	203
RSER42-8R2M	8.2	0.47	0.52	173	106	120
RSER42-100M	10	1.42	1.58	116	218	294
RSER42-150M	15	1.42	1.58	116	115	144
RSER42-220M	22	1.42	1.58	116	65	85
RSER42-300M	30	3.98	4.4	58	133	177
RSER42-470M	47	3.98	4.4	58	65	70
RSER42-680M	68	3.98	4.4	58	36.5	47.5
RSER42-101M	100	12.1	13.4	35	73	96.5
RSER42-151M	150	12.1	13.4	35	35.5	44.5
RSER42-231M	230	12.1	13.4	35	20	26.5

※ 所有数据基于环境温度 25°C 条件下测试。

All data is tested on 25°C ambient temperature.

※1 电感值测试条件为 100kHz, 1.0V。

Inductance is tested at 100kHz, 1.0V.

※2 温升电流：使产品温度上升到 $\Delta T 40^\circ\text{C}$ 时所加载的直流电流值 ($T_a=25^\circ\text{C}$)。

Heat rating current: The value of DC current when product temperature rise is $\Delta T 40^\circ\text{C}$ ($T_a=25^\circ\text{C}$).

※3 饱和电流：电感值下降到其初始值的 30% 时所加载的电流值。

Saturation current: The value of DC current when the inductance decreases 30% of its value.

※4 特别提示：线路设计，组件布局，使用频率，散热系统等均会影响产品温度，请务必验证产品实际发热状况。

Special remind: Circuit design, component placement, frequency, cooling system and etc.

all will affect the product temperature. Please verify the actual product temperature in the final application.

2 外形尺寸(mm)

Appearance and dimensions

3.6~8.2μH

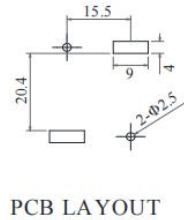
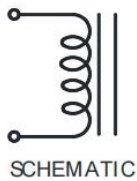
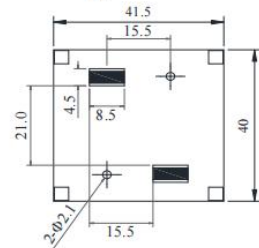
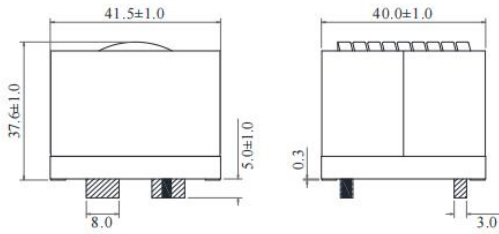

10~22μH

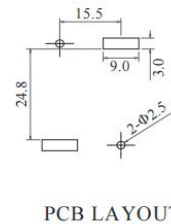
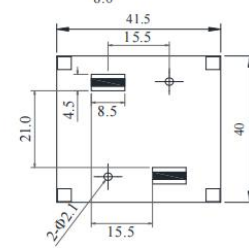
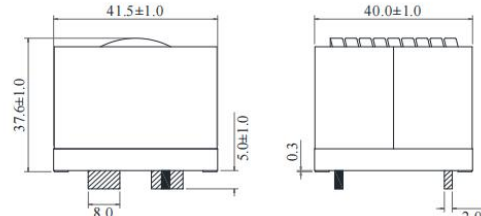

30~68μH

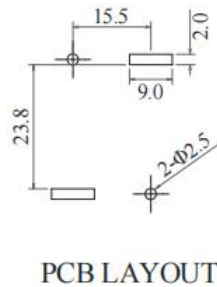
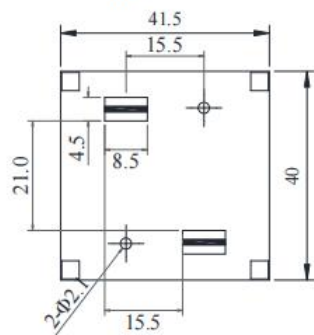
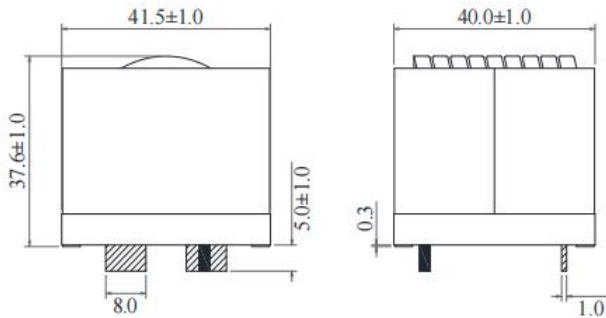

100~230μH

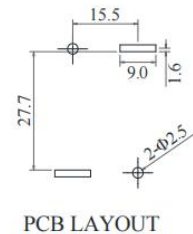
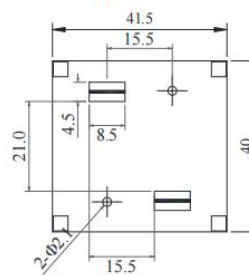
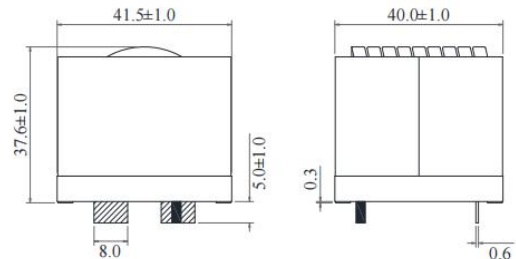

3 原理图 Schematic

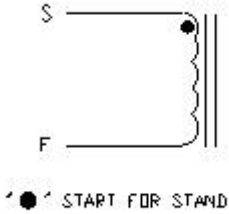

4 饱和电流曲线 saturation current curve

